

A-2. Detail Info

EX. QIS WOW II Drawing

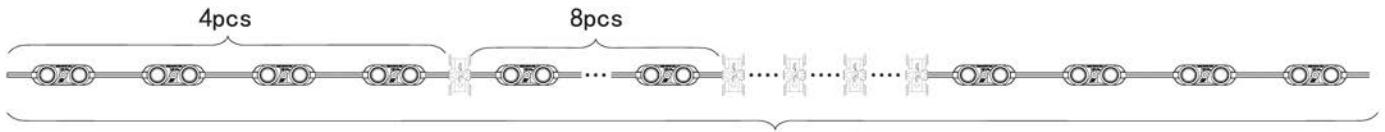

Modules	First Connector is after	Connector Spacing	Single-End/Double-End Female Connector
Little Giant	2nd module	4 modules	Single-End
Yo	5th module	10 modules	Single-End
WOW Series	3rd module	6 modules	Single-End
WOW II Series	4th module	8 modules	Double-End
Anpro 180 Series	4th module	8 modules	Double-End
Anpro 180 Plus Series	4th module	8 modules	Double-End
Anpro 160 Series	4th module	8 modules	Double-End
Trident DF 160	2nd module	8 modules	Single-End
Trident SF 160/180	2nd module	8 modules	Single-End
Enterprise	2nd module	2 modules	Single-End
Anpro180 SF/DF Stick	/	Middle of stick	Double-End
Anpro 180 Plus SF/DF Stick	/	Middle of stick	Double-End
RGB	Before 1st module	8 modules	Single-End
RGBW	Before 1st module	10 modules	Single-End
Flex/Flex Mini	/	Each Unit	Double-End
G2G Edge	/	Each Unit	Single-End&Double-End

*Based on the application, different modules have a varying number of single-end female or double-end female connectors.

QIS Overview

Quick Installation System(QIS) comes as a plug and play system. Proprietary pre-wired female connectors found on module chain accept G2G's male connector utilizing water tight rubber seals to seamlessly secure your connection. No wire nuts needed. (IP rating: IP67)

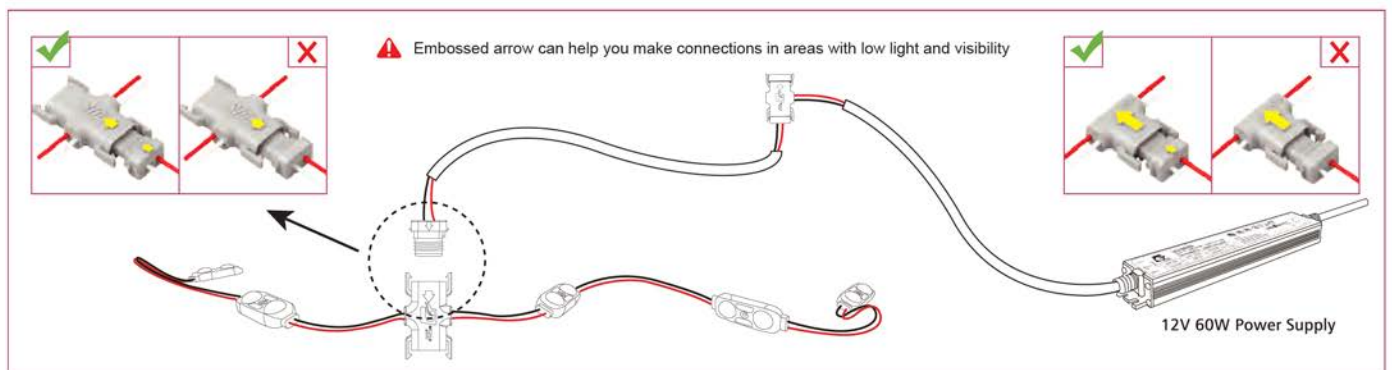

B-1. LED Module Installation Overview in Sign Cabinet (Single-end Female Connector)

Option1:

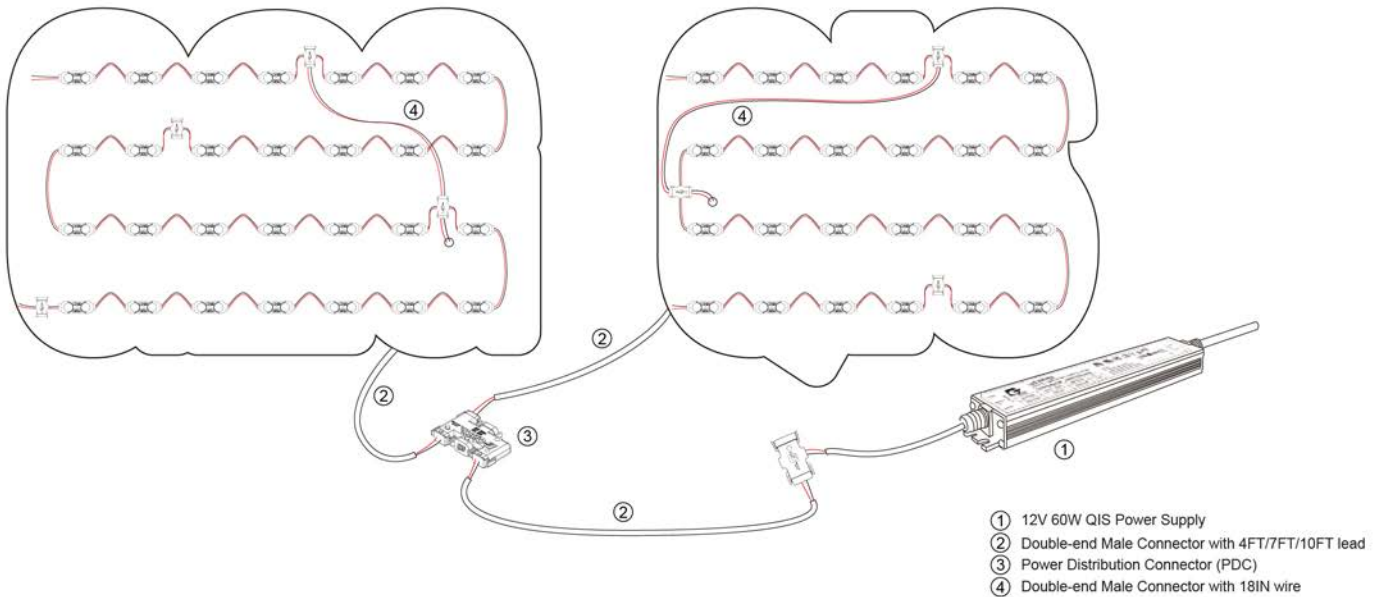

1. Install QIS modules inside of the sign cabinet .
2. Insert the double end male connector into a female connector found on the module chain.
3. Wire 7/10ft Jacketed Cable to Power Distribution Connector and connect the power supply in the same fashion.

B-2. LED Module Installation Overview in Channel Letter (Double-end Female Connector)

Option2:

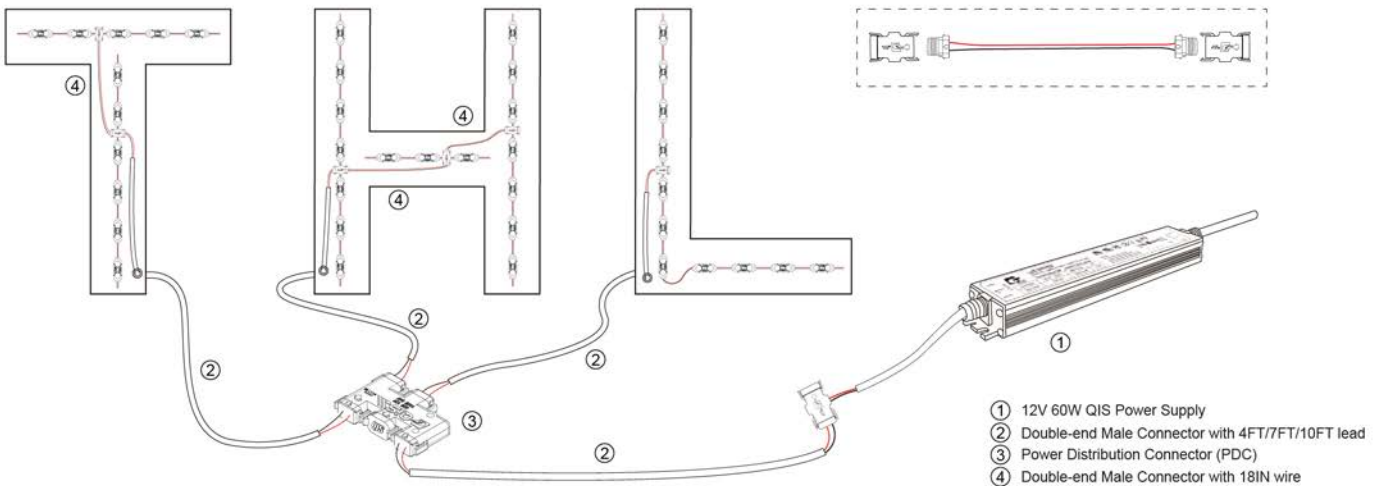

1. Install QIS modules inside of the channel letter.
2. Insert the double end male connector into a centrally located female connector found on the module chain.
3. Wire 7/10ft Jacketed Cable to Power Distribution Connector and connect the power supply in the same fashion.

B-1. LED Stick Application in Small Sign Cabinet

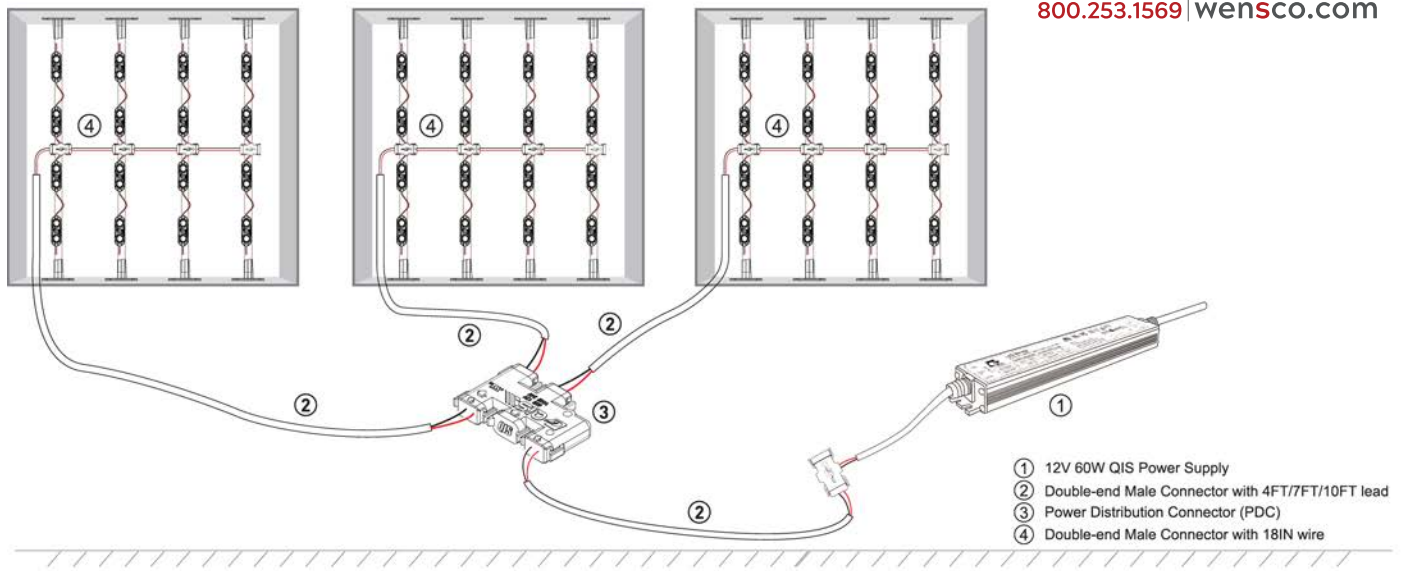

1. Install the QIS sticks in the cabinet.
2. Use the 18" double-end male connector to connect each stick together as shown above.
3. Use Double-end male connector to connect sticks to the Power Distribution Connector.
4. Use appropriate length Double-end male connector to connect G2G power supply to PDC.

B-2. LED Stick Application in Big Sign Cabinet

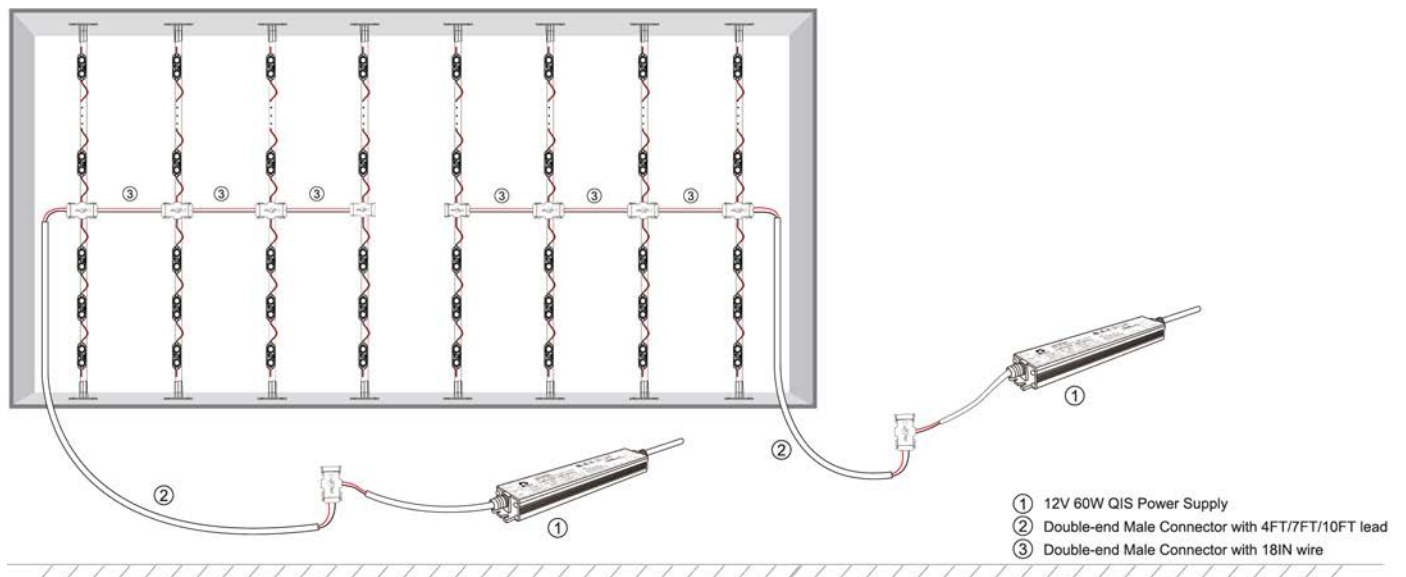

1. Install the QIS sticks inside the cabinet.
2. Use Double-end male connector with 18in wire to connect each stick.
3. Use appropriate length Double-end connector to connect power supply to stick.

C-1. RGB Module Installation Overview

Option1:

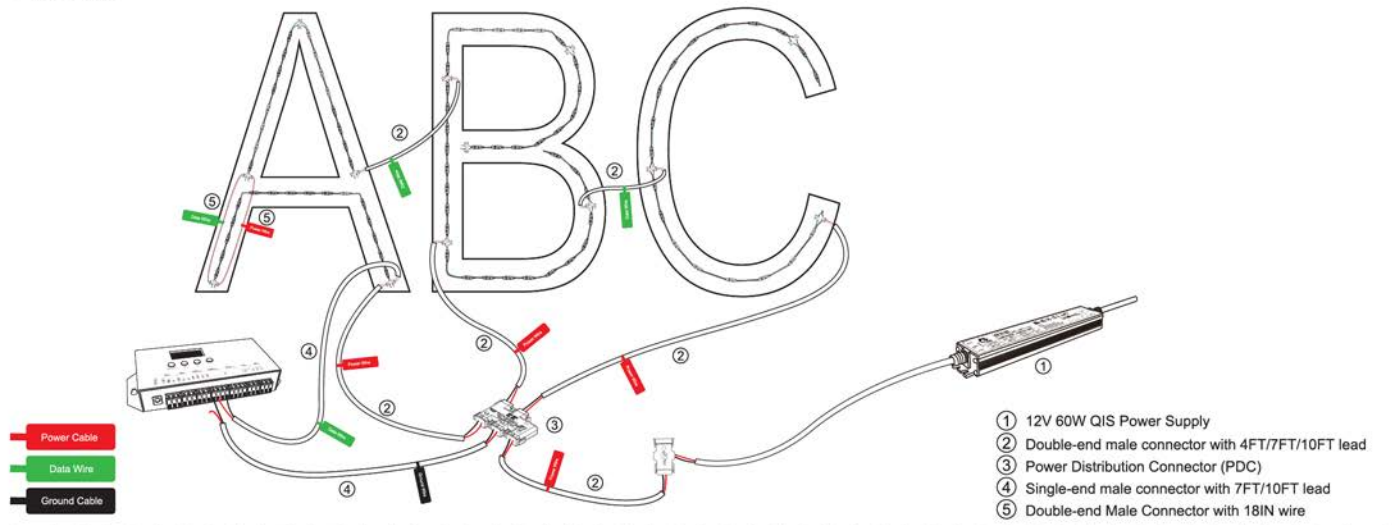

1. Install the RGB modules in the channel letter following the G2G layout and connect power like G2G QIS White Modules.
 2. Connect Single-end male connector to controller, connect and daisy chain the modules as shown in the wiring diagram.
 3. Using a single-end male connector, connect to the first PDC connector for power. Connect the bare black wire to the port, as indicated in the wiring diagram. Terminate the red wire.
- *Must daisy chain PDCs if more than one power supply is used, follow the wiring diagram on layout.

Option2:

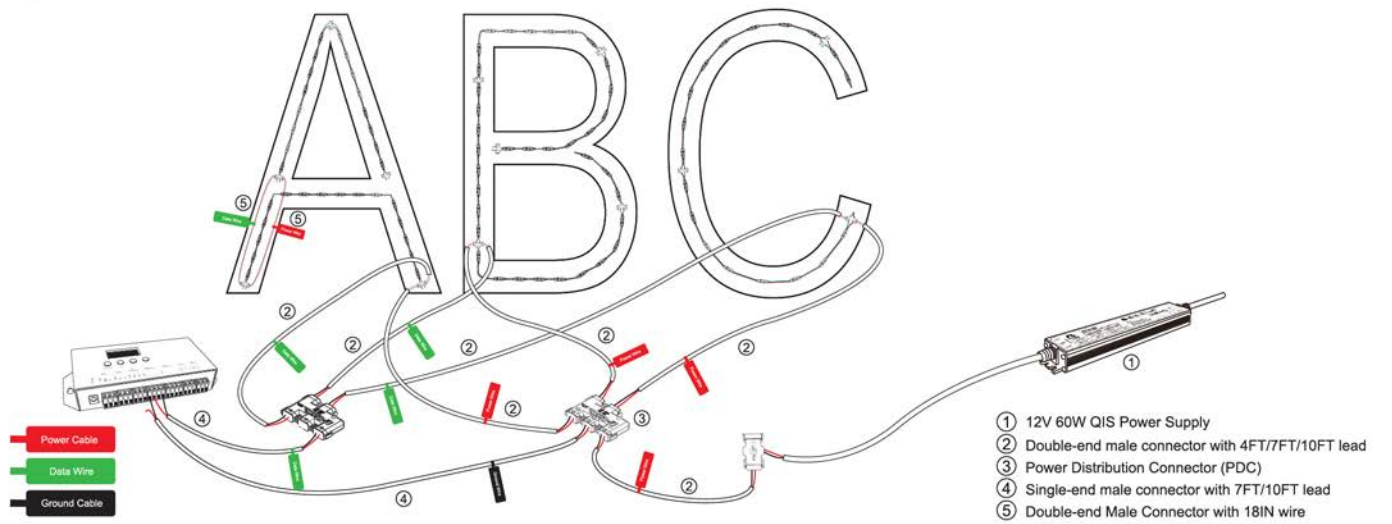

1. Install the RGB modules in the channel letter following G2G layout and connect up power like G2G QIS White modules.
 2. Using the double end male connector, connect to the data female port. Connect the other end to a PDC dedicated to data.
 3. Using a single end male connector, connect from the PDC connector. Connect the bare wires to the port on the controller, as instructed in wiring diagram.
 4. Using a single male connector, connect to the first PDC connector for power. Connect the bare black wire to the port, as indicated in wiring diagram. Terminate the red wire.
- *Must daisy chain PDCs if more than one power supply is used, follow the wiring diagram on layout.

C-2. Aurora Flex Installation Overview

Option1:

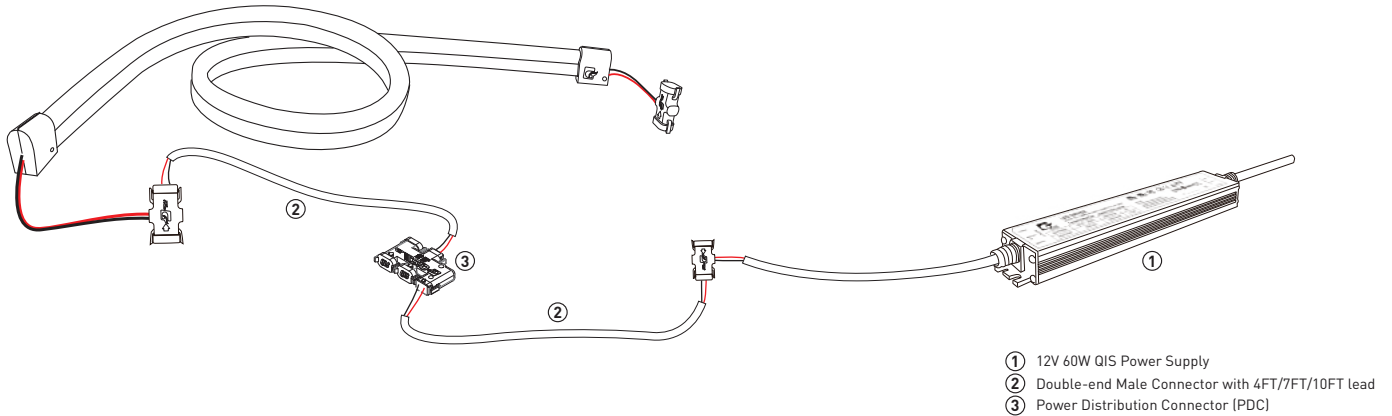

1. Following the G2G layout, install the Aurora Flex Series product.
2. Connect double end male connector to the power end of the Aurora Flex. Connect other end to a PDC.
3. Connect a double end male connector to the PDC and power supply.
4. Repeat steps 1 and 2 for additional pieces of flex. (Remember to follow proper power supply loading guidelines.)

Option2:

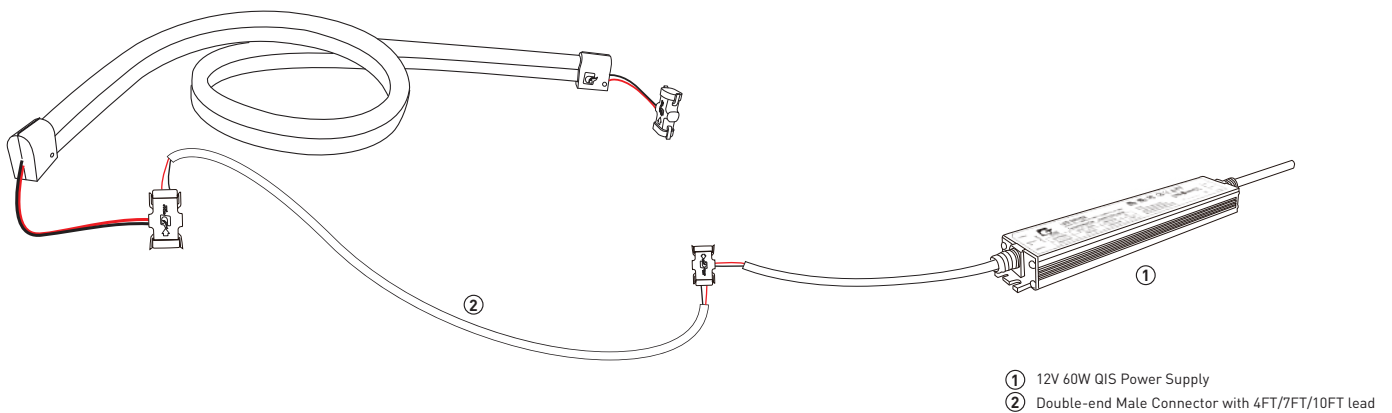

1. Following the G2G layout, install the Aurora Flex Series product.
2. If at full load connect directly to the power supply.

C-3. G2G Edge RGB Installation Overview

Option1:

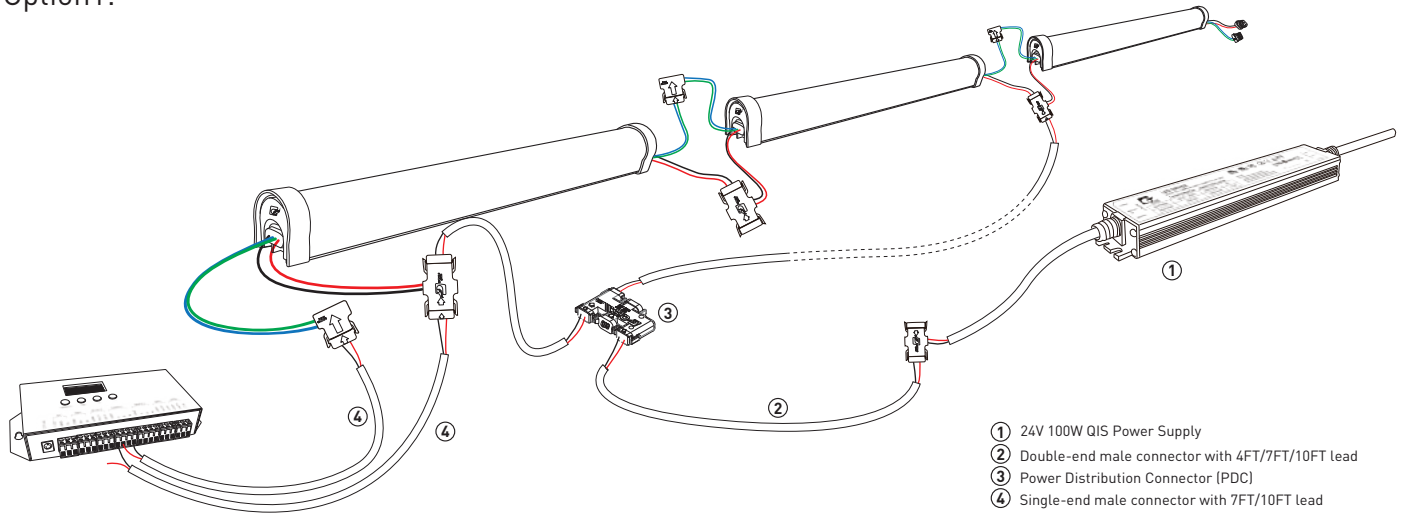

1. Following the layout, install G2G Edge.
2. Connect power supply to PDC using double end male connector.
3. Connect PDC to power end of the Edge using a double end male connector.
4. Connect single end male connector to the controller for data to the port as instructed on the layout. Connect male connector to the data connector on the edge.
5. Connect single-end male connector to the power PDC and run the black wire back to the controller. Must daisy chain the PDC for negative. Follow layout.

Option2:

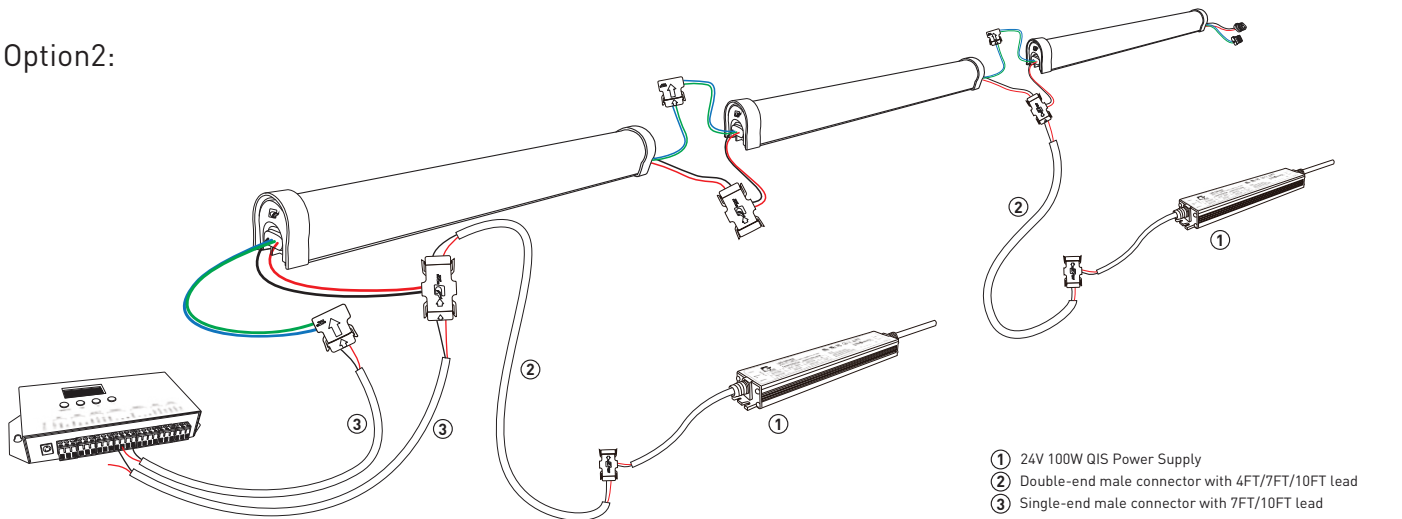

1. Following the layout, install G2G Edge.
2. Connect the power supply to the power end of the G2G Edge using a double end connector.
3. IF RGB, connect single-end male connector to the controller for data to the port as instructed on the layout. Connect male connector to the data connector on the Edge.
4. Connect a Single male connector to the power end of edge and run the black wire back to the controller. Follow the layout.

C-3. G2G Edge Installation Overview

Option1:

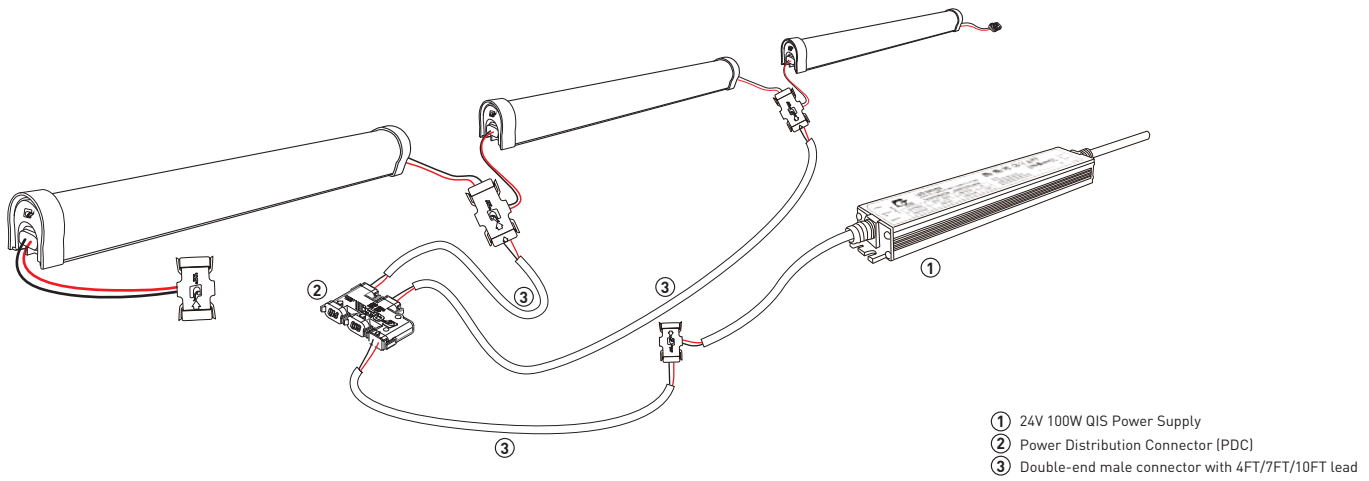

1. Following the layout, install G2G Edge.
2. Connect the power supply to the power end of the G2G Edge to the PDC using a double end male connector. Repeat as many pieces as necessary. Make sure to follow proper loading guides.
3. Repeat with each power supply as necessary.

Option2:

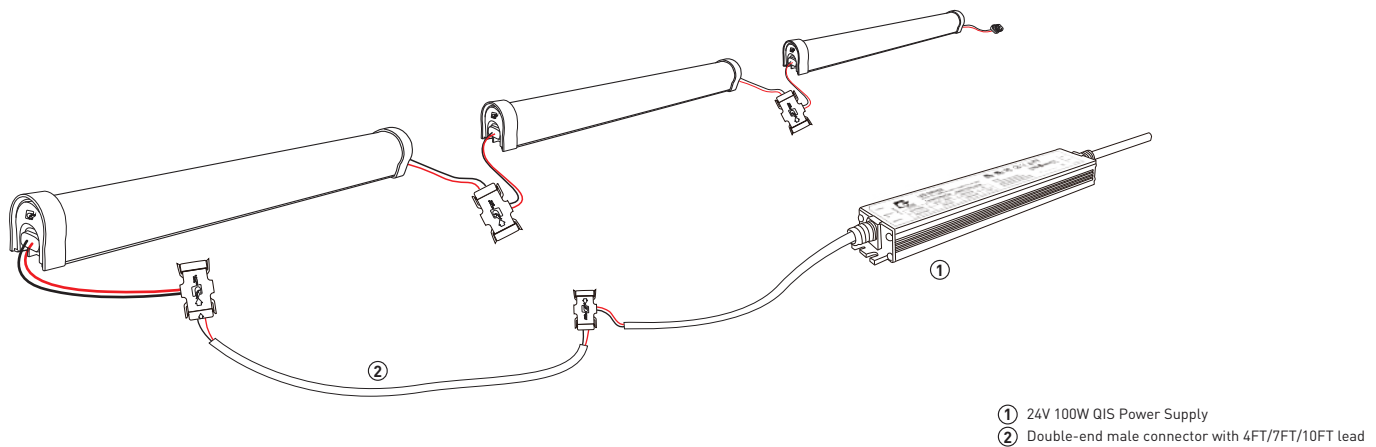

1. Following the layout, install G2G Edge.
2. Connect power end of the G2G end to the power supply. Using our the male connector on the opposite end, daisy chain as many pieces required. (Make sure to follow proper loading guidelines).
3. Repeat with each power supply as necessary.

POWER SUPPLY

Feature

- 100-277VAC Input
- 12VDC and 24VDC Outputs available
- -25 to 50°C operating temperature
- UL/cUL Recognized
- Packaging: 10pcs/box
- Warranty: 5 Years



Specification

Items	Dimensions	Nominal Input Voltage	Max. Output Current	Power Output	Operating Temperature
G2G-QISM-60W-12VDC	7.99in x 1.38in x 0.79in	100-277 VAC, 50-60Hz	5 A	60W 12VDC, Class 2 output	-25° C to + 50° C
G2G-QISM-120W-12VDC	10.08in x 1.77in x 0.91in	100-277 VAC, 50-60Hz	5 A*2	120W 12VDC, Class 2 output	-25° C to + 50° C
G2G-QISM-100W-24VDC	10.08in x 1.77in x 0.91in	100-277 VAC, 50-60Hz	4 A	100W 24VDC, Class 2 output	-25° C to + 50° C

PACKING

Modules	Box	Case
Little Giant	60pcs/chain, 60pcs/bag	10bags
Yo	80pcs/chain, 80pcs/bag	10bags
WOW Series	60pcs/chain, 60pcs/bag	10bags
WOW II Series	40pcs/chain, 80pcs/bag	10bags
Anpro 180 Series	40pcs/chain, 80pcs/bag	10bags
Anpro 180 Plus Series	40pcs/chain, 80pcs/bag	10bags
Anpro 160 Series	40pcs/chain, 80pcs/bag	10bags
Trident DF 160	20pcs/chain, 20pcs/bag	10bags
Trident SF 160 / 180	20pcs/chain, 20pcs/bag	10bags
Enterprise	8pcs/chain, 8pcs/bag	12bags
Anpro180 SF/DF Stick	6pcs	12pcs
Anpro 180 Plus SF/DF Stick	6pcs	12pcs
Trident SF 180 Stick	6pcs	12pcs
Trident DF 160 Stick	6pcs	12pcs
RGB	40pcs/chain, 80pcs/bag	10bags
RGBW	20pcs/chain, 20pcs/bag	10bags

Accessories	Box	Case
Double-end Male Connector 18in Wire (18AWG)	100pcs	600pcs
Double-end Male Connector 4ft Jacketed Cable (18AWG)	20pcs	120pcs
Double-end Male Connector 7ft Jacketed Cable (18AWG)	20pcs	120pcs
Double-end Male Connector 10ft Jacketed Cable (16AWG)	10pcs	60pcs
Single-end Male Connector 7ft Jacketed Cable (18AWG)	20pcs	120pcs
Single-end Male Connector 10ft Jacketed Cable (16AWG)	10pcs	60pcs
Power Distribution Connector (PDC)	20pcs	



G2G LED WARRANTY (QIS)



G2G LIGHTING LLC is committed to provide the following limited warranty for G2G LED purchased directly from G2G LIGHTING or authorized G2G LIGHTING distributors from May 15th, 2019. If G2G modules listed below fail due to defects, within the time periods set in our terms, G2G LIGHTING will provide a credit for the product to be replaced and credit toward labor charges.

Coverage:

This limited warranty is in effect for the Warranty Period of each product listed on the attached schedule. If a Product has been deemed defective in its materials or workmanship, G2G LIGHTING will repair or replace at no charge, excluding labor.

G2G LIGHTING provides limited material and labor warranty within certain time periods. This limited warranty is automatically voided by the use of non-approved third party controls, power supplies or any other manufacturer's components.

Procedure:

To activate this limited warranty and be eligible for our limited warranty coverage provided hereunder. You must complete and submit our online limited warranty registration form within 90 days.

To submit a warranty claim, you must complete and submit our online warranty claim form, which can be found at www.g2glighting.com/cn/downloads/list_6.aspx?lcid=126&cid=126#menu.

Once your warranty claim has been submitted, G2G LIGHTING will provide you with a Return Goods Authorization (RGA) Number and instructions on how to move forward. We will also provide information on when and where to return the defective product. Failure to follow this procedure will void this warranty.

Limited Warranty Terms & Conditions

1. All G2G LIGHTING products listed below will be free to defects in material and workmanship from the date of original purchase from G2G LIGHTING or from an authorized G2G LIGHTING distributor.
2. G2G LIGHTING reserves the right to modify this limited warranty from time to time. Any such modification shall be effective for all purchases made after the effective date of such revised limited warranty.
3. This limited warranty covers the reasonable cost of labor actually incurred for the removal of defective G2G LIGHTING products and the installation of replacement G2G LIGHTING products, up to a maximum of \$500 per location for labor in 60 months for materials and labor combined. G2G LIGHTING will directly reimburse the installer for such labor in the form of a credit for purchasing additional products from G2G LIGHTING.
4. This limited warranty is void if the G2G LIGHTING product has not been used, installed, operated and maintained in accordance with G2G Lighting's instructions, or if said product has been subject to accident, neglect, abuse, misuse or acts of God.
5. This limited warranty shall not apply to any G2G LIGHTING product which is used, installed, operated or maintained in violation of any applicable standard, code or instructions for use, including, without limitation, those contained in the Standards for Safety of Underwriters Laboratory, Inc. (UL).
6. This limited warranty does not cover G2G LIGHTING products that are not defective. However, in certain instances, where there are multiple or catastrophic failures of their products, G2G LIGHTING may decide, at its sole discretion, to replace or issue credit for, in addition to the defective products, non-defective products that you have purchased from G2G LIGHTING.
7. This limited warranty does not cover any third-party products or devices used in conjunction with the G2G LIGHTING product, however, this decision is at G2G LIGHTING's sole and exclusive discretion.
8. This limited warranty shall only be effective if the purchase receipt for the product is available for inspection by G2G LIGHTING and a G2G LIGHTING representative has reasonable access to the failed products. The G2G representative shall also have the right to invite other manufacturers' representatives to evaluate the lighting system components. All failed products need to ship back to G2G lighting.
9. If an identical replacement product is not reasonably available, G2G LIGHTING reserves the right, at its

- sole discretion, to replace the defective product with a similar product.
10. This Warranty is void if customer is in default on any portion of its payment obligations to G2G LIGHTING or authorized G2G LIGHTING distributor.
 11. In the event that a customer intends to conduct any tests on any G2G LIGHTING product alleged to be defective or subject to this limited warranty, the conditions of such test shall be mutually agreed upon by the customer and G2G LIGHTING. The actual test shall be scheduled by mutual agreement, and G2G LIGHTING and its representatives may be present at any such tests. Any tests conducted in violation of the terms of this paragraph shall void this limited warranty.
 12. Each and every provision of any applicable law, regulation, and/or clause which is required by any applicable law or regulation to be inserted into this Warranty shall be deemed to be inserted herein, and this limited warranty shall be read and enforced as though it were included herein.
 13. No agent, distributor or dealer is authorized to change, modify or extend the terms of this limited warranty on behalf of G2G LIGHTING.
 14. This limited warranty and all matters connected with the performance thereof shall be construed, interpreted, applied and governed in all respects by the laws of the State of New Jersey in the United States of America. Any action, suit or proceeding arising out of or relating to this Limited Warranty and/or to the purchase of Products covered by this limited warranty, shall be held exclusively in the State or Federal courts located within the State of New Jersey (U.S.A.).

G2G LIGHTING Warranty Period Schedule

CHANNEL LETTER PRODUCTS

Anpro Series

Model	Part No.	Duration	Labor
Anpro 160 6300k	QIS M2002	84 Months	60 Months
Anpro 180 7500K	QIS M2003	84 Months	60 Months
Anpro 180 6300K	QIS M2004	84 Months	60 Months
Anpro 180 5000K	QIS M2005	84 Months	60 Months
AnPro 180 Plus 7500K	QIS M2006	84 Months	60 Months
AnPro 180 Plus 6300K	QIS M2007	84 Months	60 Months
AnPro 180 Plus 5000K	QIS M2008	84 Months	60 Months

Yo Series

Model	Part No.	Duration	Labor
Yo 7500K	M6001	84 Months	60 Months

Wow Series

Model	Part No.	Duration	Labor
WOW 7500K	QIS M4001	84 Months	60 Months
WOW 6300K	QIS M4002	84 Months	60 Months
WOW 4200K	QIS M4003	84 Months	60 Months
WOW 2700K	QIS M4008	84 Months	60 Months
WOW Red	QIS M4004	84 Months	60 Months
WOW Blue	QIS M4005	84 Months	60 Months
WOW Green	QIS M4006	84 Months	60 Months
WOW Yellow	QIS M4007	84 Months	60 Months



WOW II Series

Model	Part No.	Duration	Labor
WOW II 7500K	QIS M1201	84 Months	60 Months
WOW II 6300K	QIS M1202	84 Months	60 Months
WOW II 2700K	QIS M1203	84 Months	60 Months
WOW II Red	QIS M1204	84 Months	60 Months
WOW II Green	QIS M1205	84 Months	60 Months
WOW II Blue	QIS M1206	84 Months	60 Months

Trico Series

Model	Part No.	Duration	Labor
G2G Trico RGB (DMX)	QIS M5004	60 Months	12 Months
G2G Trico L RGBW	QIS M5005	60 Months	12 Months

SIGN CABINET PRODUCTS

Enterprise Series

Model	Part No.	Duration	Labor
Enterprise 7500K	QIS M1101	84 Months	60 Months

Trident Series

Model	Part No.	Duration	Labor
G2G Trident SF 160 7500K	QIS SC2001	84 Months	60 Months
G2G Trident SF 180 7500K	QIS SC2002	84 Months	60 Months
G2G Trident DF 7500K	QIS SC2003	84 Months	60 Months

Anpro Stick Series

Model	Part No.	Duration	Labor
Anpro 180 SF Stick 30IN	QIS SC7002	84 Months	60 Months
Anpro 180 SF Stick 42IN	QIS SC7003	84 Months	60 Months
Anpro 180 SF Stick 64IN	QIS SC7004	84 Months	60 Months
Anpro 180 SF Stick 117IN	QIS SC7005	84 Months	60 Months
Anpro 180 SF Stick 2FT	QIS SC7007	84 Months	60 Months
Anpro 180 SF Stick 3FT	QIS SC7008	84 Months	60 Months
Anpro 180 SF Stick 4FT	QIS SC7009	84 Months	60 Months
Anpro 180 SF Stick 5FT	QIS SC7010	84 Months	60 Months
Anpro 180 SF Stick 6FT	QIS SC7011	84 Months	60 Months
Anpro 180 SF Stick 7FT	QIS SC7012	84 Months	60 Months
Anpro 180 SF Stick 8FT	QIS SC7013	84 Months	60 Months
Anpro 180 SF Stick 9FT	QIS SC7014	84 Months	60 Months
Anpro 180 SF Stick 10FT	QIS SC7015	84 Months	60 Months
Anpro 180 DF Stick 30IN	QIS SC8002	84 Months	60 Months
Anpro 180 DF Stick 42IN	QIS SC8003	84 Months	60 Months

Anpro 180 DF Stick 64IN	QIS SC8004	84 Months	60 Months
Anpro 180 DF Stick 117IN	QIS SC8005	84 Months	60 Months
Anpro 180 DF Stick 2FT	QIS SC8007	84 Months	60 Months
Anpro 180 DF Stick 3FT	QIS SC8008	84 Months	60 Months
Anpro 180 DF Stick 4FT	QIS SC8009	84 Months	60 Months
Anpro 180 DF Stick 5FT	QIS SC8010	84 Months	60 Months
Anpro 180 DF Stick 6FT	QIS SC8011	84 Months	60 Months
Anpro 180 DF Stick 7FT	QIS SC8012	84 Months	60 Months
Anpro 180 DF Stick 8FT	QIS SC8013	84 Months	60 Months
Anpro 180 DF Stick 9FT	QIS SC8014	84 Months	60 Months
Anpro 180 DF Stick 10FT	QIS SC8015	84 Months	60 Months
Anpro 180 Plus SF Stick 30IN (6300K)	QIS SC1101	84 Months	60 Months
Anpro 180 Plus SF Stick 42IN (6300K)	QIS SC1102	84 Months	60 Months
Anpro 180 Plus SF Stick 64IN (6300K)	QIS SC1103	84 Months	60 Months
Anpro 180 Plus SF Stick 117IN (6300K)	QIS SC1104	84 Months	60 Months
Anpro 180 Plus SF Stick 2FT (6300K)	QIS SC1105	84 Months	60 Months
Anpro 180 Plus SF Stick 3FT (6300K)	QIS SC1106	84 Months	60 Months
Anpro 180 Plus SF Stick 4FT (6300K)	QIS SC1107	84 Months	60 Months
Anpro 180 Plus SF Stick 5FT (6300K)	QIS SC1108	84 Months	60 Months
Anpro 180 Plus SF Stick 6FT (6300K)	QIS SC1109	84 Months	60 Months
Anpro 180 Plus SF Stick 7FT (6300K)	QIS SC1110	84 Months	60 Months
Anpro 180 Plus SF Stick 8FT (6300K)	QIS SC1111	84 Months	60 Months
Anpro 180 Plus SF Stick 9FT (6300K)	QIS SC1112	84 Months	60 Months
Anpro 180 Plus SF Stick 10FT (6300K)	QIS SC1113	84 Months	60 Months
Anpro 180 Plus DF Stick 30IN (6300K)	QIS SC1201	84 Months	60 Months
Anpro 180 Plus DF Stick 42IN (6300K)	QIS SC1202	84 Months	60 Months
Anpro 180 Plus DF Stick 64IN (6300K)	QIS SC1203	84 Months	60 Months
Anpro 180 Plus DF Stick 117IN (6300K)	QIS SC1204	84 Months	60 Months
Anpro 180 Plus DF Stick 2FT (6300K)	QIS SC1205	84 Months	60 Months
Anpro 180 Plus DF Stick 3FT (6300K)	QIS SC1206	84 Months	60 Months
Anpro 180 Plus DF Stick 4FT (6300K)	QIS SC1207	84 Months	60 Months
Anpro 180 Plus DF Stick 5FT (6300K)	QIS SC1208	84 Months	60 Months
Anpro 180 Plus DF Stick 6FT (6300K)	QIS SC1209	84 Months	60 Months
Anpro 180 Plus DF Stick 7FT (6300K)	QIS SC1210	84 Months	60 Months
Anpro 180 Plus DF Stick 8FT (6300K)	QIS SC1211	84 Months	60 Months
Anpro 180 Plus DF Stick 9FT (6300K)	QIS SC1212	84 Months	60 Months
Anpro 180 Plus DF Stick 10FT (6300K)	QIS SC1213	84 Months	60 Months
Anpro 180 Plus SF Stick 30IN (7500K)	QIS SC1301	84 Months	60 Months
Anpro 180 Plus SF Stick 42IN (7500K)	QIS SC1302	84 Months	60 Months
Anpro 180 Plus SF Stick 64IN (7500K)	QIS SC1303	84 Months	60 Months
Anpro 180 Plus SF Stick 117IN (7500K)	QIS SC1304	84 Months	60 Months
Anpro 180 Plus SF Stick 2FT (7500K)	QIS SC1305	84 Months	60 Months
Anpro 180 Plus SF Stick 3FT (7500K)	QIS SC1306	84 Months	60 Months
Anpro 180 Plus SF Stick 4FT (7500K)	QIS SC1307	84 Months	60 Months
Anpro 180 Plus SF Stick 5FT (7500K)	QIS SC1308	84 Months	60 Months
Anpro 180 Plus SF Stick 6FT (7500K)	QIS SC1309	84 Months	60 Months
Anpro 180 Plus SF Stick 7FT (7500K)	QIS SC1310	84 Months	60 Months
Anpro 180 Plus SF Stick 8FT (7500K)	QIS SC1311	84 Months	60 Months
Anpro 180 Plus SF Stick 9FT (7500K)	QIS SC1312	84 Months	60 Months
Anpro 180 Plus SF Stick 10FT (7500K)	QIS SC1313	84 Months	60 Months
Anpro 180 Plus DF Stick 30IN (7500K)	QIS SC1401	84 Months	60 Months
Anpro 180 Plus DF Stick 42IN (7500K)	QIS SC1402	84 Months	60 Months
Anpro 180 Plus DF Stick 64IN (7500K)	QIS SC1403	84 Months	60 Months
Anpro 180 Plus DF Stick 117IN (7500K)	QIS SC1404	84 Months	60 Months
Anpro 180 Plus DF Stick 2FT (7500K)	QIS SC1405	84 Months	60 Months
Anpro 180 Plus DF Stick 3FT (7500K)	QIS SC1406	84 Months	60 Months
Anpro 180 Plus DF Stick 4FT (7500K)	QIS SC1407	84 Months	60 Months
Anpro 180 Plus DF Stick 5FT (7500K)	QIS SC1408	84 Months	60 Months
Anpro 180 Plus DF Stick 6FT (7500K)	QIS SC1409	84 Months	60 Months
Anpro 180 Plus DF Stick 7FT (7500K)	QIS SC1410	84 Months	60 Months
Anpro 180 Plus DF Stick 8FT (7500K)	QIS SC1411	84 Months	60 Months
Anpro 180 Plus DF Stick 9FT (7500K)	QIS SC1412	84 Months	60 Months
Anpro 180 Plus DF Stick 10FT (7500K)	QIS SC1413	84 Months	60 Months

Aurora Flex Series

Model	Part No.	Duration
Aurora Flex Blue	QIS AF1001	36 Months
Aurora Flex White 7500k	QIS AF1002	36 Months



800.253.1569 | wensco.com

Aurora Flex Mini Blue	QIS AF2001	36 Months
Aurora Flex Mini White 7500K	QIS AF2002	36 Months
Aurora Flex Mini White 3500K	QIS AF2003	36 Months
Aurora Flex Mini Ice Blue	QIS AF2004	36 Months
Aurora Flex Mini Red	QIS AF2005	36 Months
Aurora Flex Mini Yellow	QIS AF2006	36 Months
Aurora Flex Mini Lemon Yellow	QIS AF200601	36 Months
Aurora Flex Mini Green	QIS AF2007	36 Months
Aurora Flex Mini Orange	QIS AF2008	36 Months
Aurora Flex Mini Pinkish Purple	QIS AF2009	36 Months
Aurora Flex Mini Pink	QIS AF200901	36 Months
Aurora Flex Mini Red (Ruby shell)	QIS AF2010	36 Months

Edge Series

Model	Part No.	Duration
G2G Edge White 6500K 4FT	QIS E1001	60 Months
G2G Edge Red 4FT	QIS E1002	60 Months
G2G Edge Green 4FT	QIS E1003	60 Months
G2G Edge Blue 4FT	QIS E1004	60 Months
G2G Edge Novial Gold 4FT	QIS E1005	60 Months
G2G Edge RGB 4FT	QIS E1006	60 Months
G2G Edge White 6500K 8FT	QIS E2001	60 Months
G2G Edge Red 8FT	QIS E2002	60 Months
G2G Edge Green 8FT	QIS E2003	60 Months
G2G Edge Blue 8FT	QIS E2004	60 Months
G2G Edge Novial Gold 8FT	QIS E2005	60 Months
G2G Edge RGB 8FT	QIS E2006	60 Months